

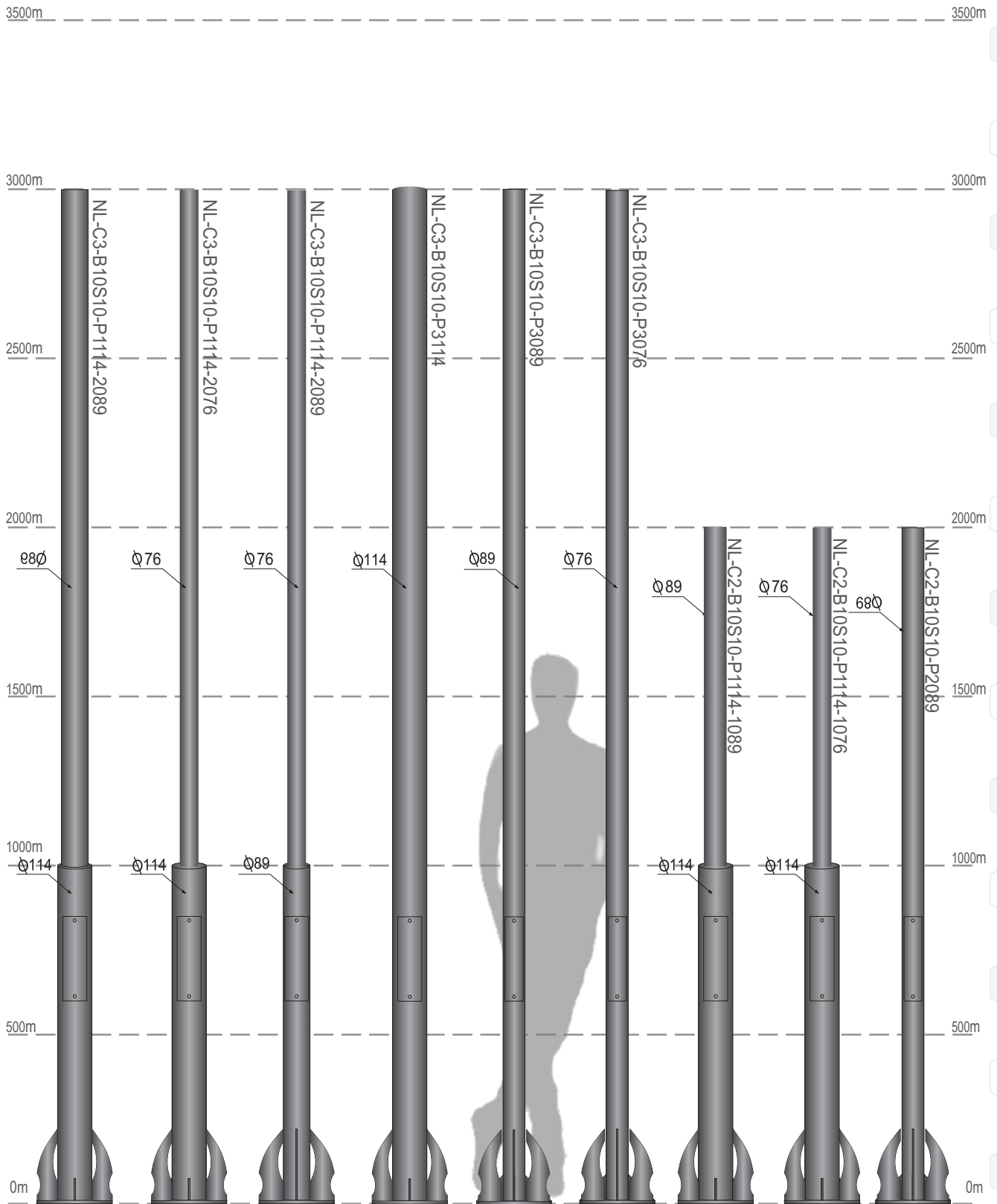

# LIGHTING COLUMNS





8000m

7000m

6000m

5000m

4000m

3000m

2000m

1000m

0m

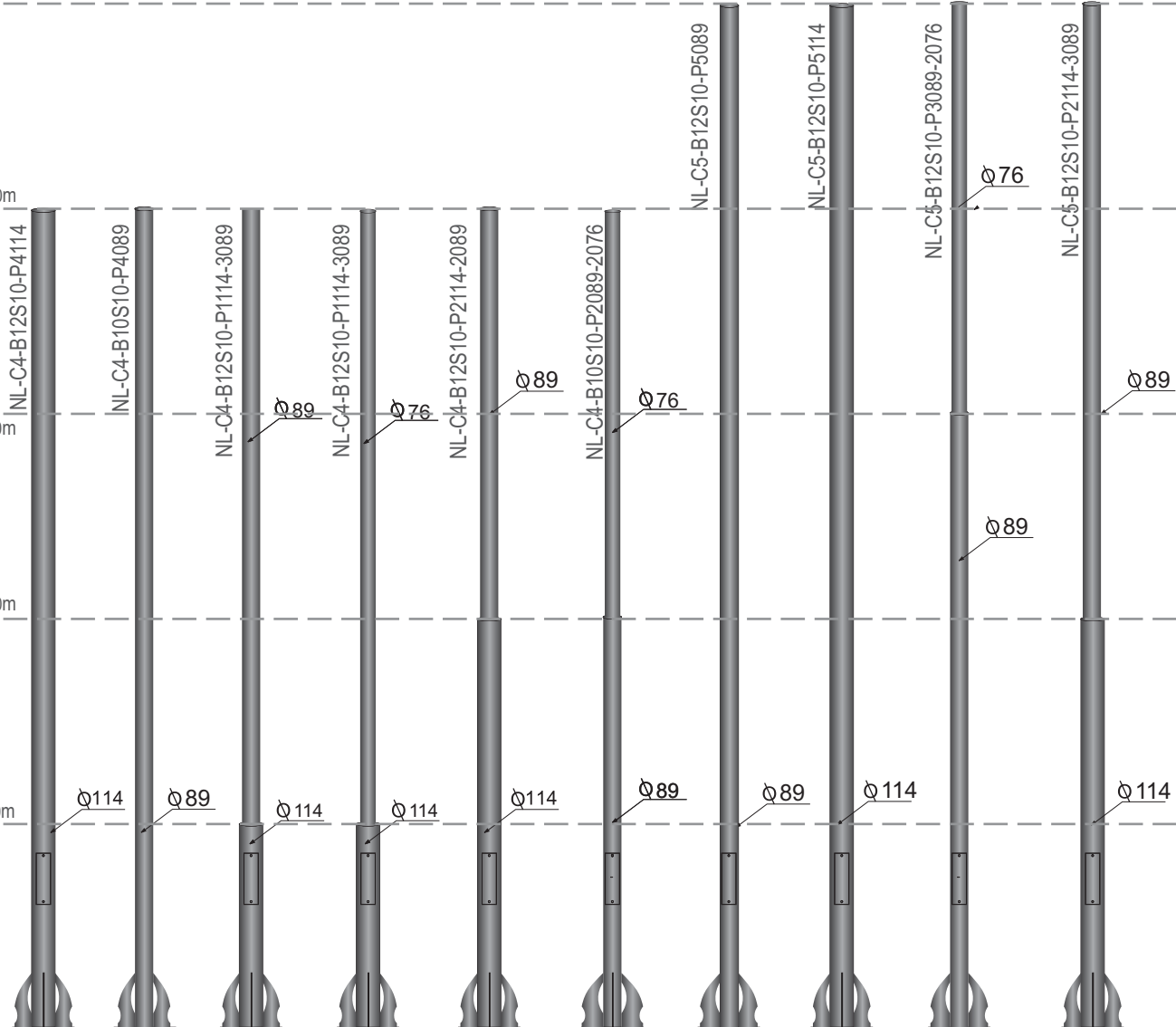

XXX



8000m

7000m

6000m

5000m

4000m

3000m

2000m

1000m

0m

LIGHTING COLUMNS

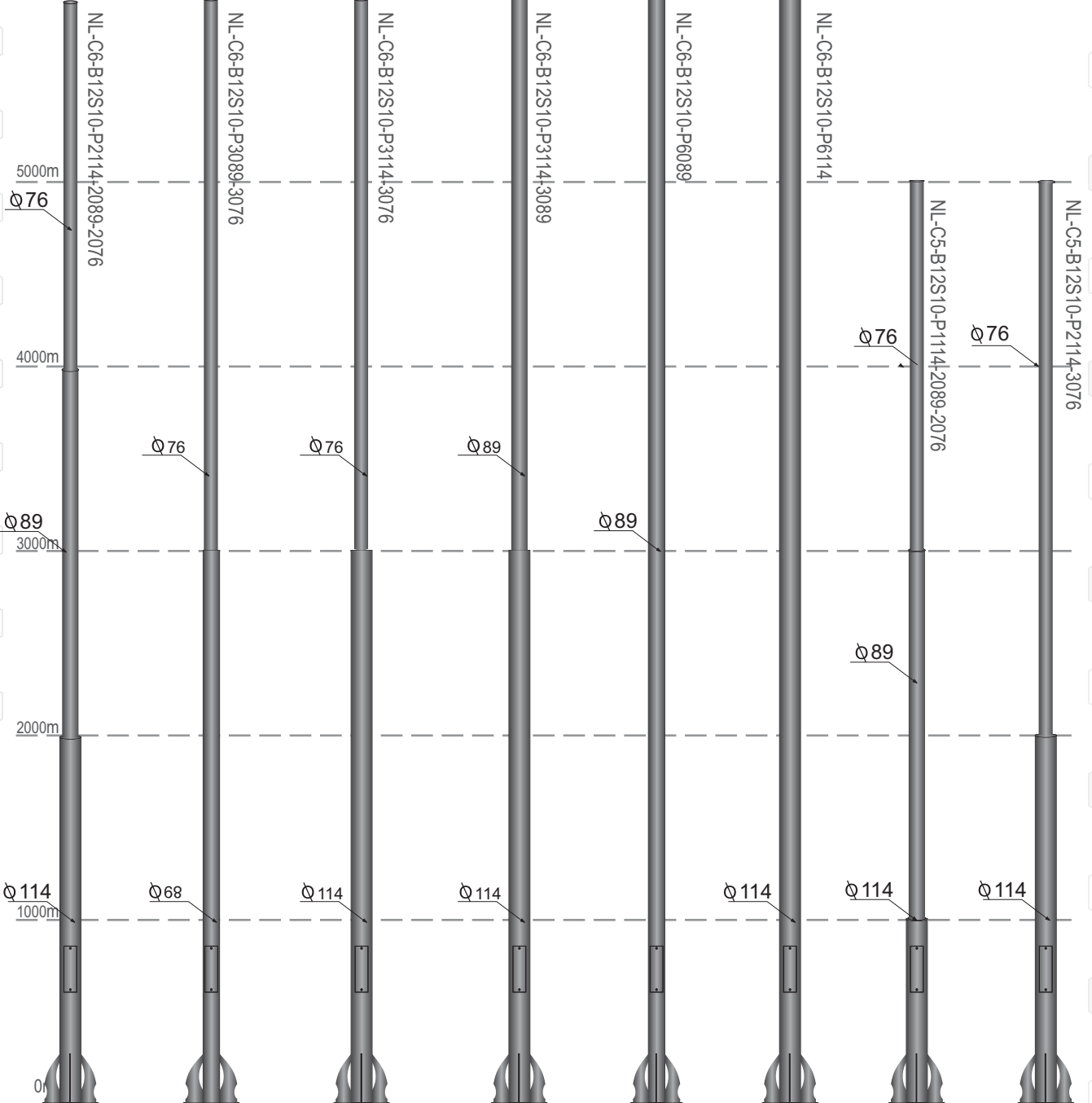

xxx

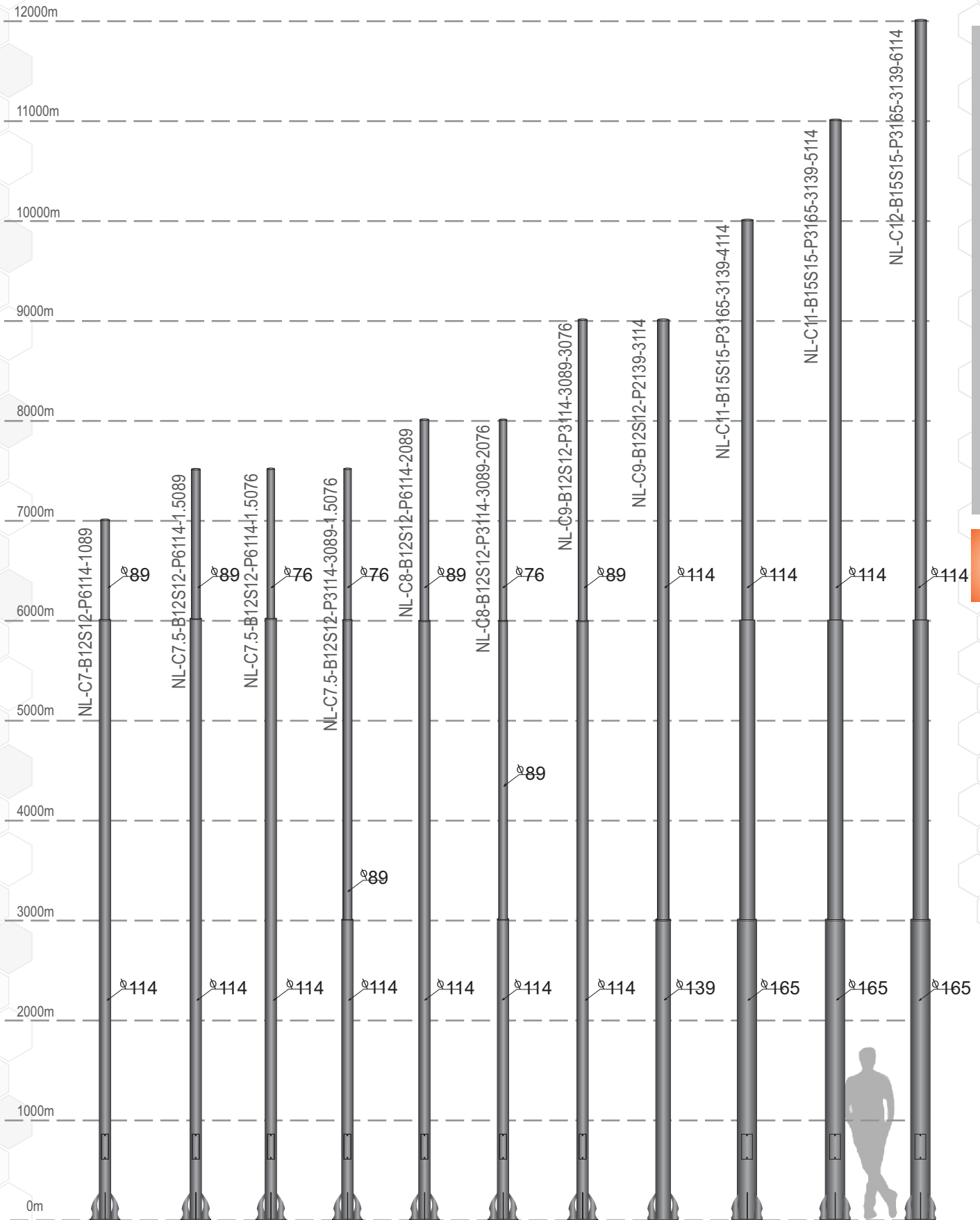

LIGHTING COLUMNS



### SWAGED POLES

Designation	Over All Length	Length of Section			Outside Diameter & Thickness			Approx
		Bottom H1	Middle H2	Top H3	Bottom	Middle	Top	
		m	m	m	mm	mm	mm	
4 10SP-1	7	4	1.5	1.5	114.3X3.65	88.9X3.25	76.1x3.25	62
4 10SP-2	7	4	1.5	1.5	114.3X4.50	88.9X4.05	761x3.25	73
4 10SP-3	7	4	1.5	1.5	114.3X5.40	88.9X4.85	75.x1x3.25	85
4 10SP-4	7.5	4.5	1.5	1.5	114.3X3.65	88.9X3.25	76.9x3.25	67
4 10SP-5	7.5	4.5	1.5	1.5	114.3X4.50	88.9X4.05	76.1x3.25	79
4 10SP-6	7.5	4.5	1.5	1.5	114.3X5.40	88.9X4.85	76.1x3.25	93
4 10SP-7	7.5	4.5	1.5	1.5	114.3X4.50	114.3X3.65	88.9x3.25	97
4 10SP-8	7.5	4.5	1.5	1.5	139.7X4.85	114.3X3.65	88.9x3.25	103
4 10SP-9	7.5	4.5	1.5	1.5	139.7X5.40	114.3X3.65	88.9x3.25	110
4 10SP-10	8	4.5	1.75	1.75	114.3X3.65	88.9X3.25	76.1x3.25s	70
4 10SP-11	8	4.5	1.75	1.75	114.3X4.50	88.9X4.05	76.1x3.25	83
4 10SP-12	8	4.5	1.75	1.75	114.3X5.40	88.9X4.85	76.1x3.25	97
4 10SP-13	8	4.5	1.75	1.75	139.7X4.50	114.3X3.65	88.9x3.25	101
4 10SP-14	8	4.5	1.75	1.75	139.7X4.85	114.3X4.50	88.9x3.25	111
4 10SP-15	8	4.5	1.75	1.75	139.7X5.40	114.3X4.50	88.9x3.25	119
4 10SP-16	8.5	5	1.75	1.75	114.3X3.65	88.9x3.25	76.1x3.25	75
4 10SP-17	8.5	5	1.75	1.75	114.3X5.40	88.9x4.05	76.1x3.25	89
4 10SP-18	8.5	5	1.75	1.75	114.3X5.40	88.9x4.85	76.1x3.25	104
4 10SP-19	8.5	5	1.75	1.75	139.7X4.50	114x3.3.65	88.9x3.25	109
4 10SP-20	8.5	5	1.75	1.75	139.7X4.85	114x3.3.65	88.9x3.25	115
4 10SP-21	8.5	5	1.75	1.75	139.7X5.40	114x3.450	88.9x3.25	129
4 10SP-22	8.5	5	1.75	1.75	165.1X4.50	139.7x4.50	114.3x3.65	141
4 10SP-23	8.5	5	1.75	1.75	165.1X4.85	139.7x4.50	114.3x3.65	148
4 10SP-24	8.5	5	1.75	1.75	165.1X5.40	139.7x4.50	114.3x3.65	158
4 10SP-25	9	5	1.75	1.75	114.3X3.65	8.9x3.25	76.1x3.25	78
4 10SP-26	9	5	1.75	1.75	114.3X4.50	88.9x4.05	76.1x3.25	92
4 10SP-27	9	5	2	2	114.3X5.40	88.9x4.85	76.1x3.25	108
4 10SP-28	9	5	2	2	139.7X4.50	114.3x3.65	88.9x3.25	113
4 10SP-29	9	5	2	2	139.7X4.85	114.3x3.65	88.9x3.25	125
4 10SP-30	9	5	2	2	139.7X5.40	114.3x4.50	8.9x3.25	133
4 10SP-31	9	5	2	2	165.1X4.50	114.3x4.50	114.3x3.65	147
410SP-32	9	5	2	2	165.1x4.85	139.7x4.50	114.3x3.65	154
410SP-33	9	5	2	2	165.1x5.40	139.7x4.50	114.3x3.65	164
410SP-34	9.5	5	2.25	2.25	139.7x4.50	114.3x4.50	88.9x3.25	122
410SP-35	9.5	5	2.25	2.25	139.7x4.85	114x4.50	88.9x3.25	129
410SP-36	9.5	5	2.25	2.25	139.7x5.40	114.3x4.50	88.9x3.25	137
410SP-37	9.5	5	2.25	2.25	165.1x4.85	139.7x4.50	114.3x3.65	153
410SP-38	9.5	5	2.25	2.25	165.1x5.40	139.7x4.50	114.3x3.65	160
410SP-39	9.5	5	2.25	2.25	165.1x4.50	139.7x4.50	114.3x3.65	170
410SP-40	10	5.2	2.4	2.4	139.7x4.50	114.3x4.50	88.9x3.25	128
410SP-41	10	5.2	2.4	2.4	139.7x4.85	114.3x4.50	88.9x3.25	135
410SP-42	10	5.2	2.4	2.4	139.7x5.40	114.3x4.50	88.9x3.25	144
410SP-43	10	5.2	2.4	2.4	165.1x4.50	139.7x4.50	114.3x3.65	160
410SP-44	10	5.2	2.4	2.4	165.1x4.85	139.7x4.50	114.3x3.65	168
410SP-45	10	5.2	2.4	2.4	165.1x5.40	139.7x4.50	114.3x3.65	178
410SP-46	10	5.2	2.4	2.4	193.7x4.85	165.1x4.50	139.7x4.50	208
410SP-47	10	5.2	2.4	2.4	193.7x5.40	165.1x4.50	139.7x4.50	221
410SP-48	10	5.2	2.4	2.4	193.7x4.50	165.1x4.50	139.7x4.50	233
410SP-49	11	5.2	2.7	2.7	139.7x4.50	114.3x4.50	88.9x3.25	140
410SP-50	11	5.2	2.7	2.7	139.7x4.85	114.3x4.50	88.9x3.25	147
410SP-51	11	5.2	2.7	2.7	139.7x5.40	114.3x5.40	88.9x3.25	164
410SP-52	11	5.2	2.7	2.7	165.1x4.50	139.7x4.50	114.3x3.65	175
410SP-53	11	5.2	2.7	2.7	165.1x4.85	139.7x4.50	114.3x3.65	183
410SP-54	11	5.2	2.7	2.7	165.1x5.40	139.7x4.50	114.3x3.65	194
410SP-55	11	5.2	2.7	2.7	193.7x4.85	165.1x4.50	139.7x4.50	227
410SP-56	11	5.2	2.7	2.7	193.7x5.40	165.1x4.50	139.7x4.50	240
410SP-57	11	5.2	2.7	2.7	193.7x5.90	165.1x4.85	139.7x4.50	256
410SP-58	12	5.8	3.1	3.1	16.1x4.50	139.7x4.50	114.3x3.65	186
410SP-59	12	5.8	3.1	3.1	165.1x4.85	139.7x4.50	114.3x3.65	197
410SP-60	12	5.8	3.1	3.1	165.1x5.40	139.7x4.50	114.3x3.65	208
410SP-61	12	5.8	3.1	3.1	193.7x4.85	165.1x4.50	139.7x4.50	245
410SP-62	12	5.8	3.1	3.1	193.7x5.40	165.1x4.50	139.7x4.50	259
410SP-63	12	5.8	3.1	3.1	193.7x5.90	165.1x4.85	139.7x4.50	277
410SP-64	12	5.8	3.1	3.1	219.1x4.85	19.7x4.85	165.1x4.50	292
410SP-65	12	5.8	3.1	3.1	219.1x5.60	193.7x4.85	165.1x4.50	313
410SP-66	12	5.8	3.1	3.1	219.1x5.90	193.7x4.85	165.1x4.50	322
410SP-67	12	5.8	3.6	3.6	193.7x4.85	165.1x4.50	139.7x4.50	261

Height

H3

H2

H1

LIGHTING COLUMNS

## BASE PLATES

### 2-4 Meter Poles

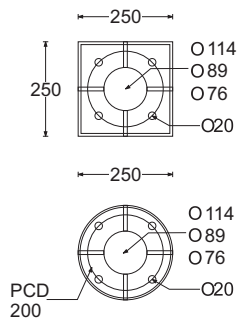

### 4 - 7.5 Meter Poles

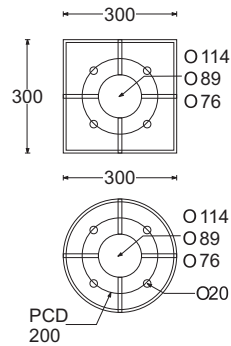

### Above 7.5 Meter Poles

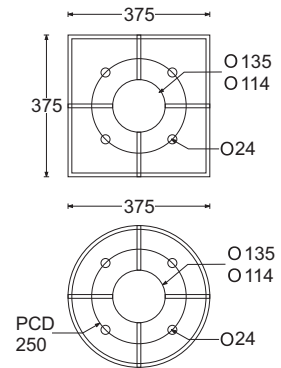

## COLUMN ARM

1.

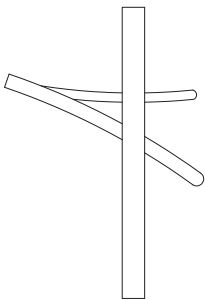

2.

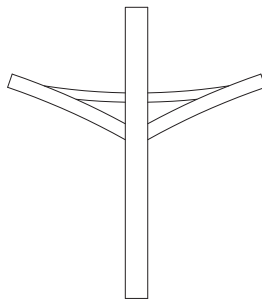

3.

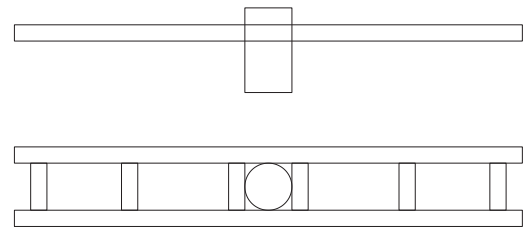

4.

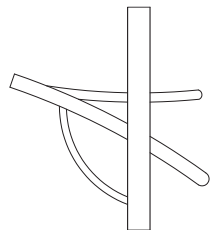

5.

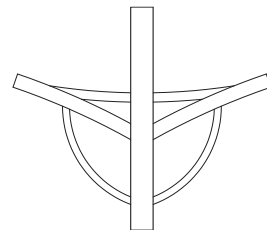

6.

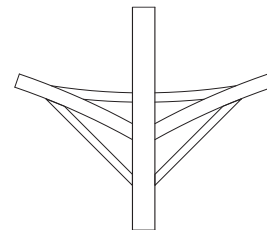

7.



8.

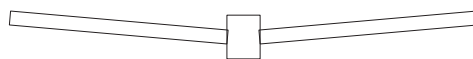

9.

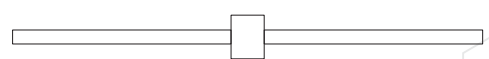

10.

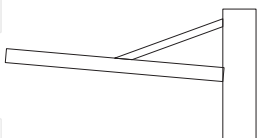

11.

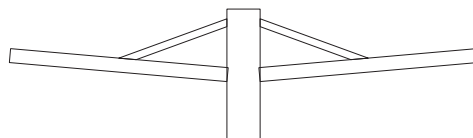

12.

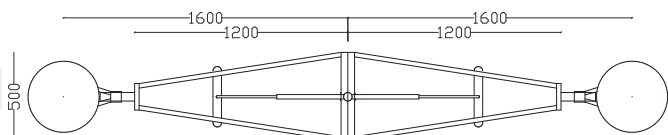
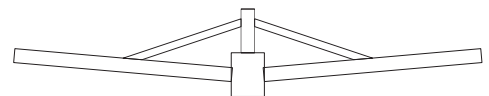

TOP VIEW

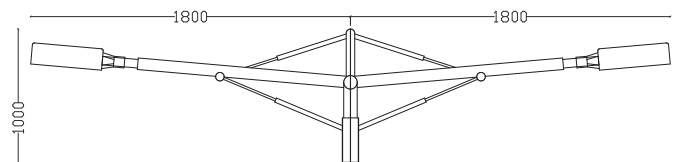

SIDE VIEW



**COLUMN ARM**

16.

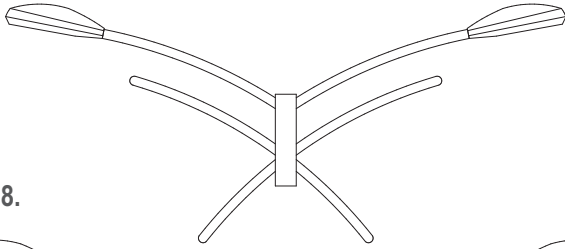

17.

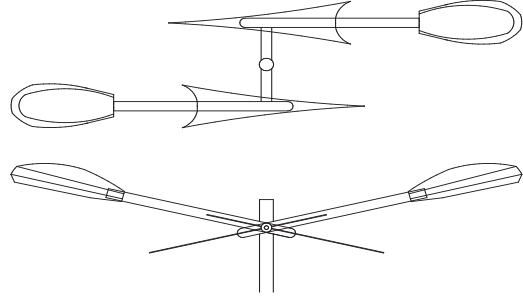

18.

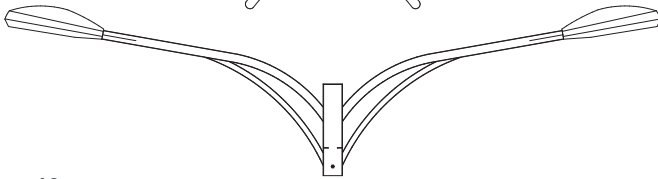

20.

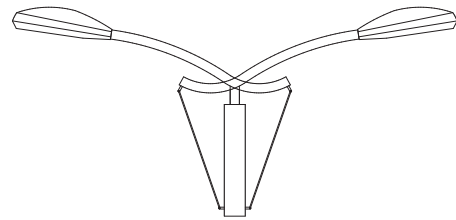

19.

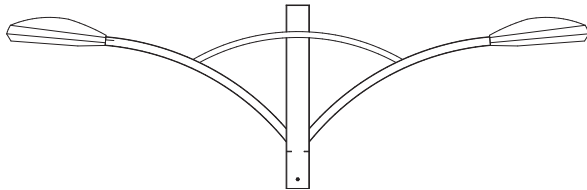

**DECORATIVE COLUMN ARM**

21.

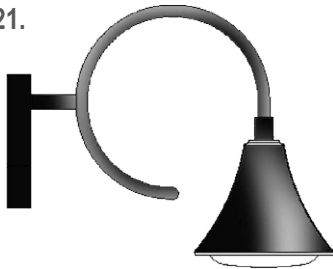

22.

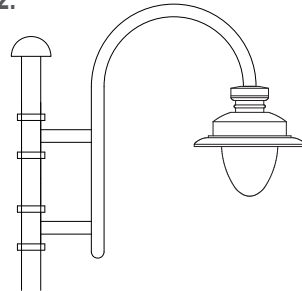

23.

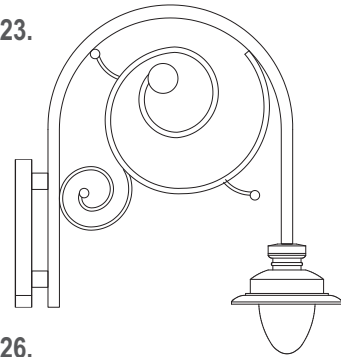

24.

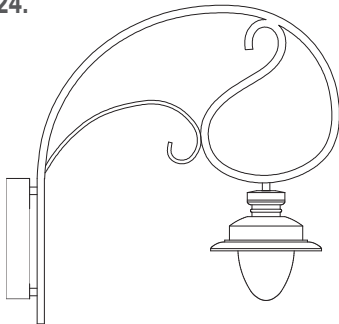

25.

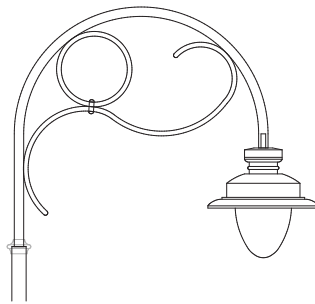

26.

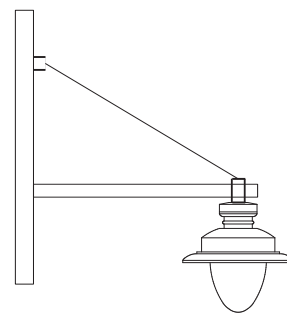

27.

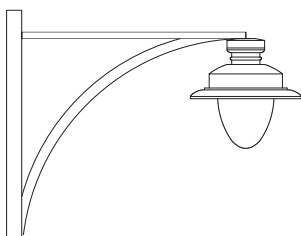

28.

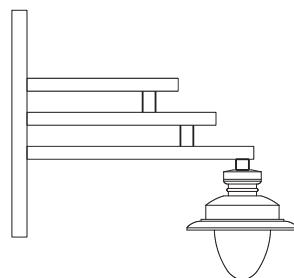

29.

